

# PITMEC

## THE PCON-E 315 CONCENTRIC UNDERREAMING SYSTEM

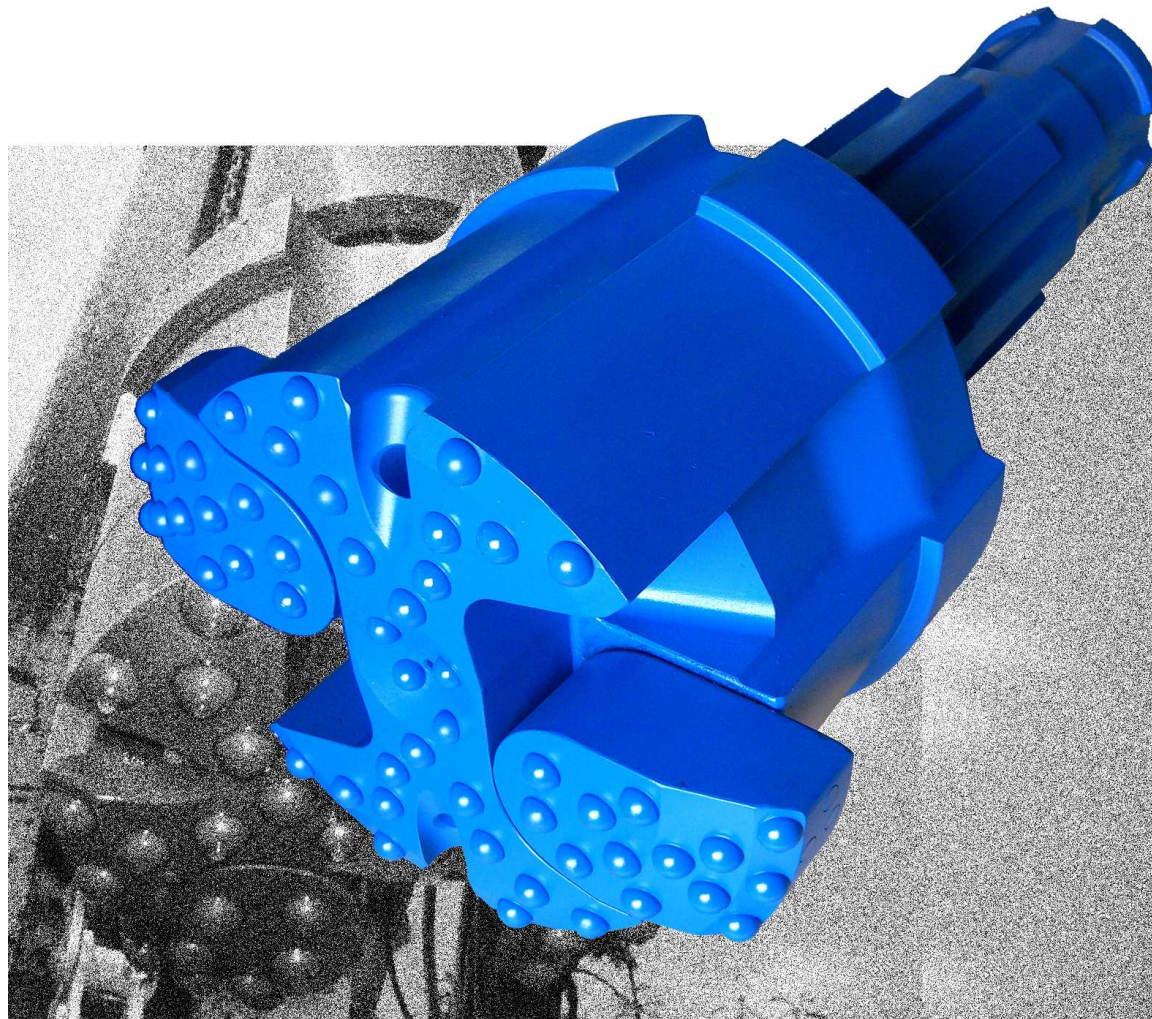

**CASING SIZE 355MM OD X 339MM ID DRILLING DIA. 380MM**

# PNEUMEC PCON-E 315 CONCENTRIC UNDERREAMING SYSTEM

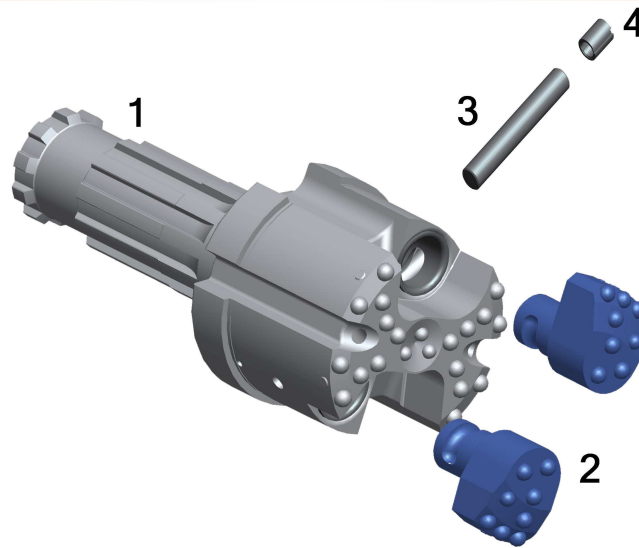

## PCON-E 315 PARTS LIST

1.	DRIVER BIT SD12 SHANK	UGD315S12PCE
2.	REAMER(2)	UBS315PCE
3.	LOCKING PIN	USP31550PCE
4.	SPLIT PIN	USP31551PCE
5.	COMPLETE SYSTEM	UCS315S12PCE

## PCON-E 315 SPECIFICATIONS

UPPER BODY DIAMETER	335MM	CLOSED DIAMETER	315MM
REAMING DIAMETER	380MM	CASING SIZE	355MM OD X 339MM ID
SYSTEM LENGTH	728MM	SYSTEM WEIGHT	260KG

## PCON-E 315 CASING SHOES

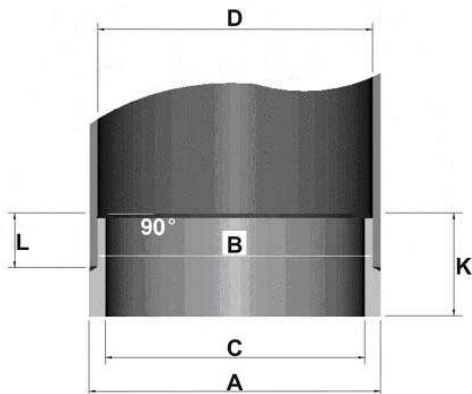

DIA. A	355MM
DIA. B	335MM
DIA. C	317MM
DIA. D	339MM
L	55MM
K	115MM

# PNEUMEC

**PNEUMEC COMPANY LIMITED**

1st Floor, Tin On Sing Comm. Bldg., 41-43 Graham St. Central, H.K.

Tel : (852) 2315 9922

Website : [www.pneumec.com](http://www.pneumec.com)

Fax : (852) 2315 9982

email : [info@pneumec.com](mailto:info@pneumec.com)